

9. Puka Place

- One bedroom apartment on second floor over storage room
- Queen bed
- Living-kitchen-dining area
- Bathroom with shower
- Screened in Porch



Woodland Park

is now on the internet!

For color photos come see us at:

<http://www.woodlandparkcottages.com>



We also have a listing of cabin availability at our site:



Please visit our site or drop us an e-mail at:

paul@woodlandparkcottages.com

WOODLAND PARK

BAR HARBOR, MAINE

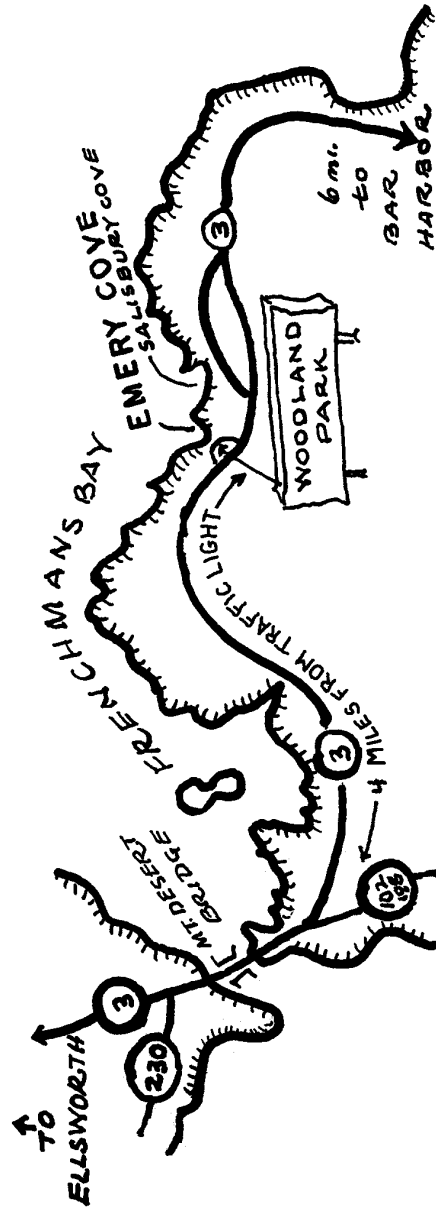

Garden and Bay View

WOODLAND PARK

HOUSEKEEPING COTTAGES

3 Woodland Loop

BAR HARBOR, MAINE 04609

(207) 288-4016

<http://www.woodlandparkcottages.com>

3 1/2 Miles to the Acadia National Park Entrance for hiking, biking, carriage rides, and swimming

6 miles to downtown Bar Harbor or take the free Island Explorer bus

Eight rustic cottages among tall fragrant evergreens by beautiful, secluded Emery Cove in Frenchman Bay



Our dock and shore

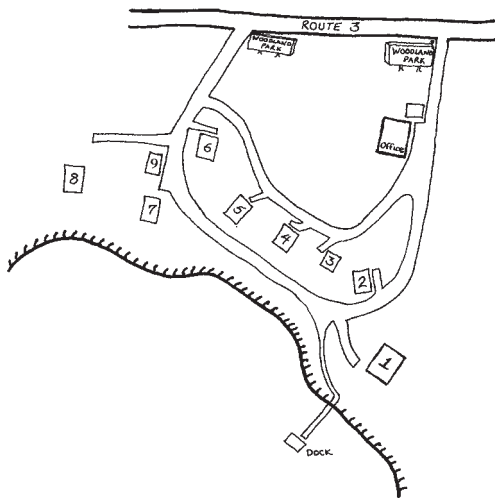

Layout of Cabins

Completely furnished for light house-keeping, including gas stove with oven, refrigerator, cooking and eating utensils, linens for bed, bath and kitchen, electric heat, and cribs available

Dock, rowboats, picnic tables, and barbecue grills are available for use by guests.

No smoking in cottages; No pets

Check-in time: 3:00 p.m.

Check-out time : 11:00 a.m.



Ledge View

Cabin

Layout

Description

1. Aloha

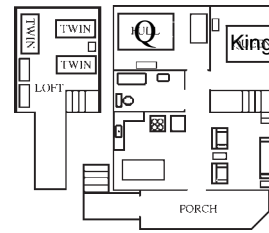

One bedroom with king bed
 One bedroom with queen bed
 Loft with 3 twin beds
 Full bathroom
 Living-kitchen-dining room
 Screened porch

2. Kamp Koze



Bedroom with queen bed
 Bedroom with 2 twin beds
 Bedroom with 1 full bed
 Living-kitchen-dining room
 Bathroom with shower
 Screened porch

3. Sea Breeze

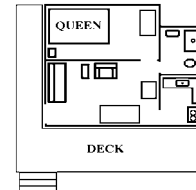

Bedroom with queen bed
 Bathroom with shower
 Living-dining room
 Kitchen
 Deck

4. Mt. View

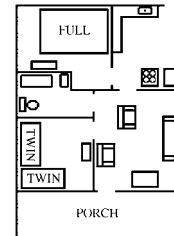

Bedroom with Queen
 Bedroom with 2 twin beds
 Bathroom with tub and shower
 Living-dining room
 Kitchen
 Screened porch

5. Bay View

6. Garden

7. Ledge View

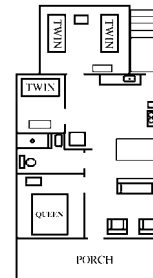

Bedroom with queen bed
 Bedroom with two twin beds
 Bedroom with one twin bed
 Living-kitchen-dining room
 Bathroom with shower
 Closed-in porch

8. Parrot



Bedroom with Queen bed
 Second floor with 3 twin beds
 2 Full bathrooms
 Living-dining-kitchen room
 Dishwasher, Gas "Wood" Stove
 Closed-in porch

| Woodland Park Cottages 2019 Price List | Price per Additional Person | 1. Aloha | 2. Koze 7. Ledge View | 4. Mt. View 5. Bay View 6. Garden | 8. Parrot | 3. Sea Breeze 9. Puka Place |
|---|------------------------------------|-----------------|----------------------------------|--|------------------|--|
| # People | | 1-5 | 1-5 | 1-4 | 1-5 | 1-2 |
| May 18 - 26 | \$80 | \$1006 | \$833 | \$692 | \$1193 | \$512 |
| May 25 - June 8 | \$90 | \$1156 | \$983 | \$842 | \$1343 | \$662 |
| June 9 - 22 | \$100 | \$1256 | \$1083 | \$942 | \$1543 | \$762 |
| June 22 - Aug 24 | \$125 | \$1570 | \$1354 | \$1178 | \$1929 | \$953 |
| Aug 24 - Sept 14 | \$100 | \$1256 | \$1083 | \$942 | \$1543 | \$762 |
| Sept 14 - Oct 12 | \$90 | \$1156 | \$983 | \$842 | \$1353 | \$662 |
| Oct 12- 19 | \$80 | \$1006 | \$833 | \$692 | \$1193 | \$512 |

Personal Checks, Travelers Checks, Cash, Credit Cards (for balance due) accepted

\$250 deposit for each week reserved, due within 10 days.
Balance of rent plus 9%* Maine lodging tax due upon arrival
(* or whatever the current tax rate is at time of arrival)

120 day cancellation notice required for refund of deposit, less \$50/week for processing
Refunds for late cancelations made only if dates reserved are filled completely at full price

NO SMOKING; NO PETS